

# MAGNUM HeatBoard (E) Cable

## Heating cable for HeatBoard system plates

Wood, parquet and laminate are durable and atmospheric products that are increasingly being used. The demand for a heating system for these floors has led to the development of a new high-tech product.

MAGNUM HeatBoard is directly applicable under floating wood, parquet or laminate floors. This thin floor heating system (only 12 mm!) is controlled by a digital WiFi thermostat with floor sensor. This ensures very even heating. The floor temperature can be limited to a maximum temperature by means of the floor sensor and thermostat.

The advanced WiFi thermostat calculates the necessary warm-up time, so that your floor always has the right temperature at the right time. This thermostat is not included in the set, must be ordered separately. The insulation plates provide additional thermal insulation and also have a sound-absorbing effect.

MAGNUM HeatBoard is very easy to cut to size. After this, the HeatBoard Cable can simply be clamped in. Approximately 9 m<sup>1</sup> (linear metres) of HeatBoard Cable is required per net/unobstructed area of 1 m<sup>2</sup>. Safe, comfortable and easy to use: MAGNUM HeatBoard ensures a comfortable living and working environment, even on dry floors!

MAGNUM HeatBoard can only be used with hard dry floor systems (laminate, wood and parquet). In the case of so-called soft floor systems (PVC laminate and vinyl), DuoBoard should first be applied between the heating system and the floor covering.

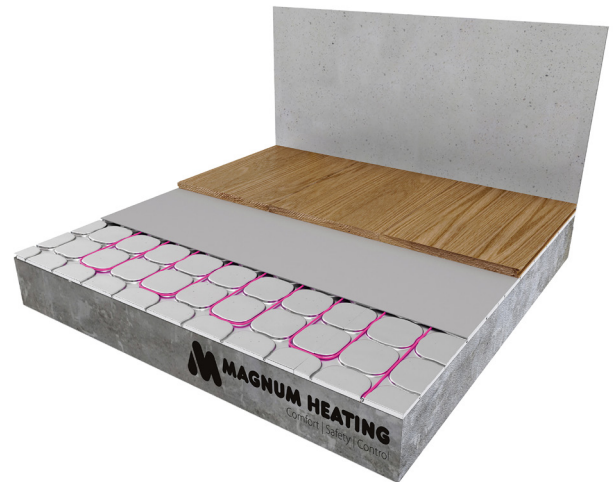

### Specifications

|                          |                                |
|--------------------------|--------------------------------|
| System type              | Electric                       |
| System height            | 12 mm                          |
| System width             | from 20 cm                     |
| System length            | 778 mm                         |
| Min. construction height | 12 mm                          |
| Installation             | Floating                       |
| Power                    | 60 or 100W/m <sup>2</sup>      |
| In wet areas             | <b>X</b>                       |
| Tiles                    | <b>X</b>                       |
| Wood                     | <b>V</b>                       |
| (PVC) Laminate           | <b>V</b> (PVC i.c.w. DuoBoard) |
| Carpet                   | <b>V</b> (i.c.w. DuoBoard)     |
| Certification            | CE, VDE                        |
| Warranty                 | 2 years                        |





## Technical details

### Installation methods

Through a new patented production process, the high-density EPS foam panels are glued to the preformed aluminium plates. This provides the MAGNUM HeatBoard system with contact over the entire floor and, in comparison to similar products, it even provides maximum heat transfer in the curves. The heat transfer from the electric 7 mm MAGNUM HeatBoard Cable is therefore optimally utilised.

With a system height of only 12 mm, MAGNUM HeatBoard is the thinnest dry construction system of its kind. The boards have a size of 788 x 594 mm (effective: 589 x 778 mm) and are supplied in a set of 11 plates (5 m<sup>2</sup>).

### Package contents

- HeatBoard E Cable
- Mounting tape
- Flexible tube for floor sensor
- Installation instructions
- Profile for end loop

HeatBoard Cable, thermostat and DuoBoard must be ordered separately.

### Warranty

10 year warranty on the electrical function of the Cable.

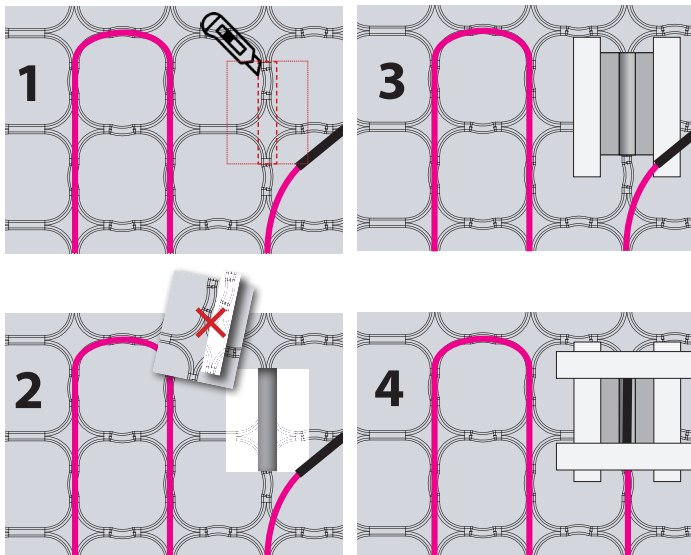

Example of the installation for Heatboard E Cable

| Art.nr. | Description (60 Watt/m <sup>2</sup> ) | Cable length | Power     |
|---------|---------------------------------------|--------------|-----------|
| 136018  | MAGNUM HeatBoard Cable 6              | 30 m         | 180 Watt  |
| 136030  | MAGNUM HeatBoard Cable 6              | 50 m         | 300 Watt  |
| 136048  | MAGNUM HeatBoard Cable 6              | 80 m         | 480 Watt  |
| 136060  | MAGNUM HeatBoard Cable 6              | 100 m        | 600 Watt  |
| 136072  | MAGNUM HeatBoard Cable 6              | 120 m        | 720 Watt  |
| 136090  | MAGNUM HeatBoard Cable 6              | 150 m        | 900 Watt  |
| 136140  | MAGNUM HeatBoard Cable 6              | 190 m        | 1140 Watt |

| Art.nr. | Description (100 Watt/m <sup>2</sup> ) | Cable length | Power     |
|---------|--|--------------|-----------|
| 131030  | MAGNUM HeatBoard Cable 10              | 30 m         | 300 Watt  |
| 131050  | MAGNUM HeatBoard Cable 10              | 50 m         | 500 Watt  |
| 131080  | MAGNUM HeatBoard Cable 10              | 80 m         | 800 Watt  |
| 131100  | MAGNUM HeatBoard Cable 10              | 100 m        | 1000 Watt |
| 131120  | MAGNUM HeatBoard Cable 10              | 120 m        | 1200 Watt |
| 131150  | MAGNUM HeatBoard Cable 10              | 150 m        | 1500 Watt |
| 131190  | MAGNUM HeatBoard Cable 10              | 190 m        | 1900 Watt |