

MAGNUM Bend support

Positioning systems and accessories

90°C bend support holds the heating tubes at an angle of 90°C and enables you to process the tubes easily and quickly. This support is very suitable to support tubes in corners when installing in ceilings, floors or support from the manifolds of the underfloor heating system.

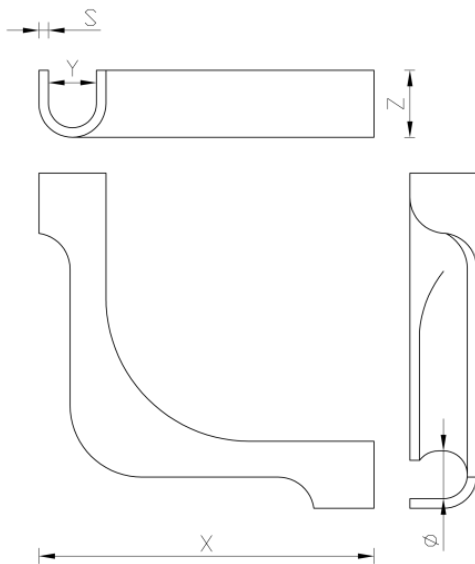

Specifications

Diameter	14 - 17 mm 18 - 20 mm
Dimensions	125 x 17 x 25 mm 140 x 20 x 39 mm
Weight	37 g 45 g
Material	PA 6 with glass fibre
Operating temperature	0°C - 65°C
Warranty	2 years



Art.nr.	Description	Dimensions
W90113	90°C Bend support	Tube size ø 14 - 17 mm 2 pieces
W90114	90°C Bend support	Tube size ø 18 - 20 mm 2 pieces